

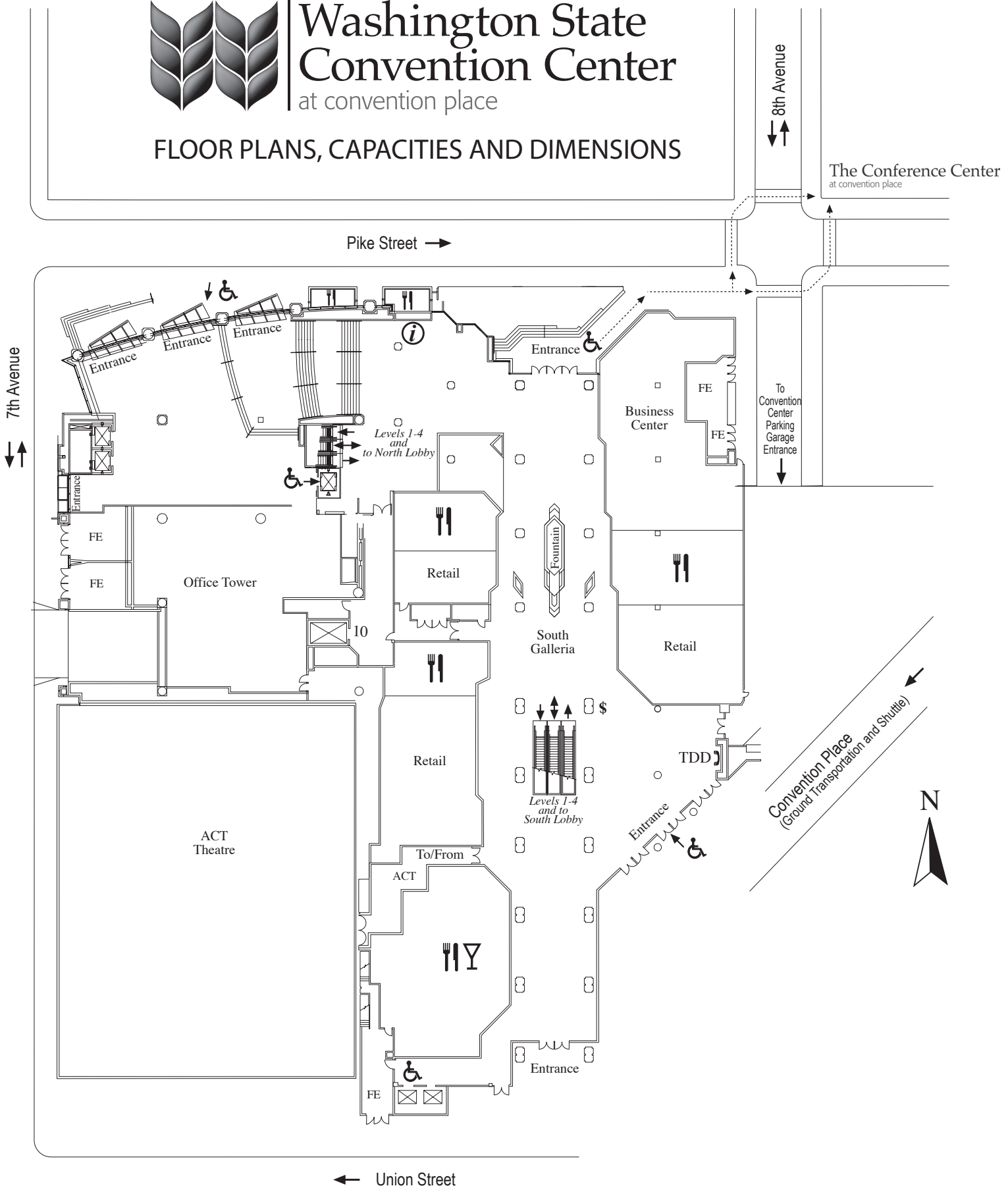

Washington State Convention Center

at convention place

FLOOR PLANS, CAPACITIES AND DIMENSIONS



Level One: Entrances, Shops and Services

Level Two: Meeting Rooms

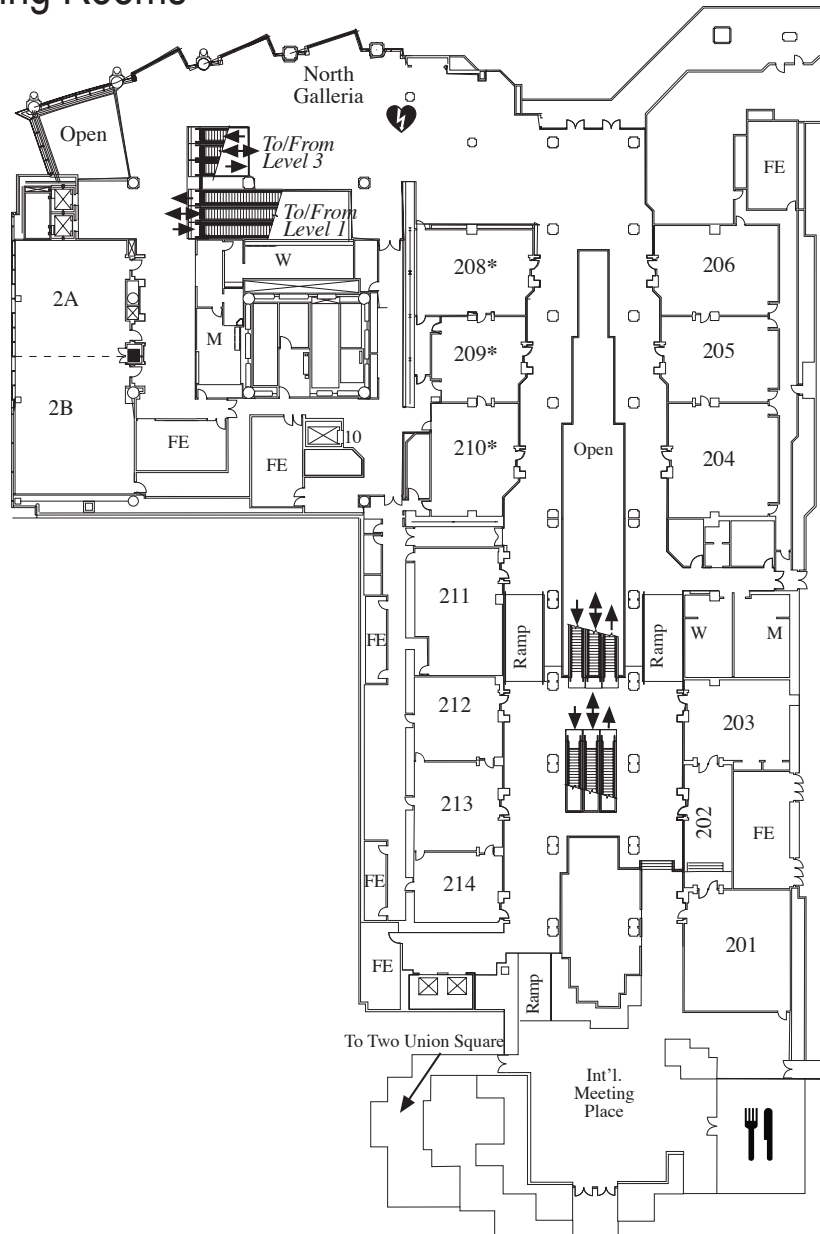

MEETING ROOMS	Square Feet	Dimensions	Height	Theater	Classroom		Banquet B-10	Conference	Recommended Front
					3pp	4pp			
Room 201	1,435	35 x 41	8'6"	128	54	72	60	40	South
Room 202	602	43 x 14	9	35	18	24	20	18	South
Room 203	1,044	36 x 29	9	75	36	49	60	32	East
Room 204	1,443	39 x 37	9	126	55	75	70	40	East
Room 205	1,073	37 x 29	8'11"	91	40	54	60	32	East
Room 206	1,302	42 x 31	9	97	42	56	60	32	East
Room 208*	1,160	40 x 29	9	-	24	-	-	24	West
Room 209*	928	32 x 29	8'10"	-	-	-	-	14	West
Room 210*	1,170	39 x 30	9	70	-	-	-	-	South
Room 211	1,247	43 x 30	9	104	42	56	70	32	South
Room 212	812	29 x 28	9	70	33	45	40	24	South
Room 213	840	30 x 28	9	75	32	44	40	24	North
Room 214	780	30 x 26	9	70	28	40	40	24	North
Room 2A	1,521	39 x 39	13	144	54	72	60	40	North
Room 2B	1,786	47 x 38	13	180	72	96	80	56	South
Rooms 2AB	3,393	87 x 39	13	360	144	192	140	88	South

Level Three: Meeting Rooms

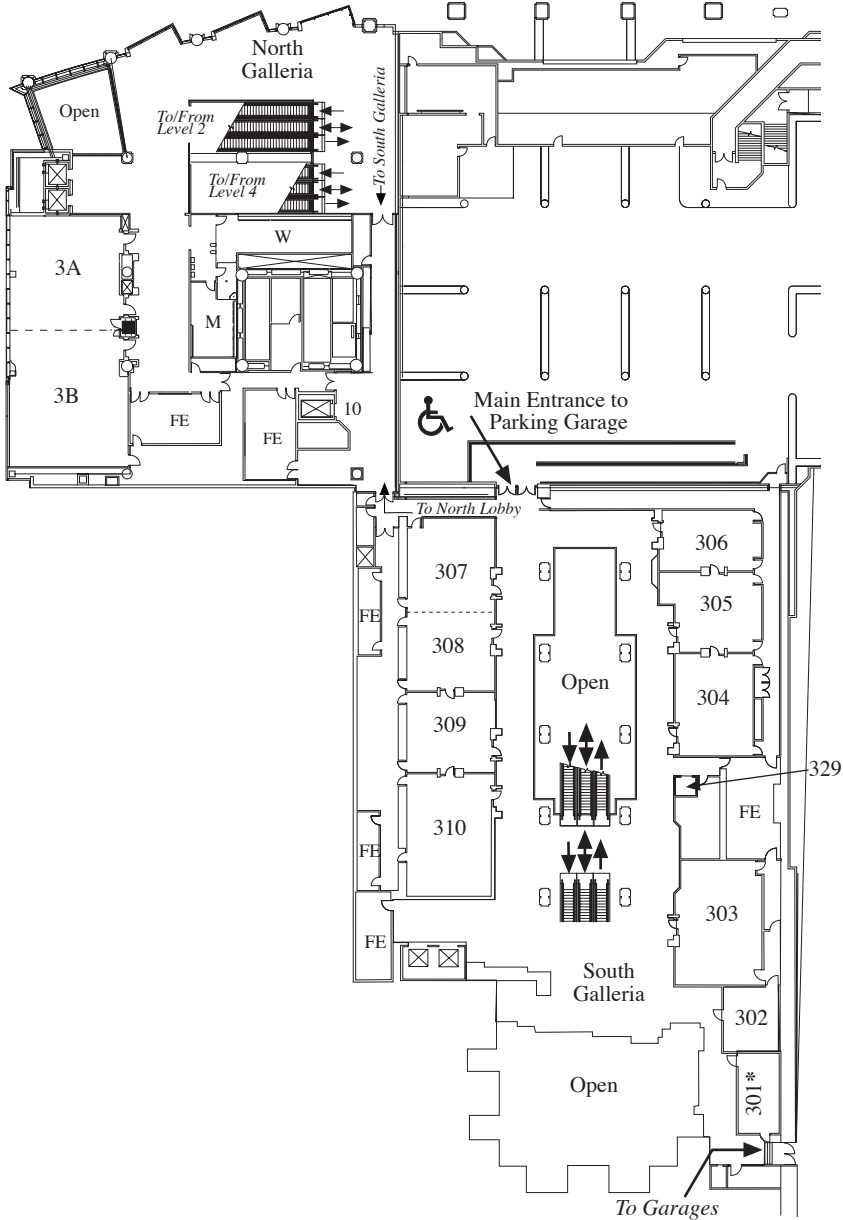

SUPPORT ROOM	
329	150 Sq. Ft.



MEETING ROOMS	Square Feet	Dimensions	Height	Theater	Classroom		Banquet B-10	Conference	Recommended Front
					3pp	4pp			
Room 301*	450	30 x 15	8'5"	-	-	-	-	12	North
Room 302	460	23 x 20	8'5"	32	12	18	20	18	South
Room 303	1,305	45 x 29	9	116	62	85	80	40	South
Room 304	918	34 x 27	9	75	30	40	40	32	North
Room 305	840	30 x 28	9'6"	55	24	32	40	24	East
Room 306	714	34 x 21	9'6"	56	<u>25</u>	<u>35</u>	30	24	East
Room 307	841	29 x 29	10	78	32	44	40	24	North
Room 308	812	28 x 29	10	70	36	44	40	24	West
Rooms 307-308	1,653	57 x 29	10	169	72	99	100	48	North
Room 309	840	28 x 29	10	60	24	32	40	24	West
Room 310	1,200	40 x 30	10	104	44	60	60	32	South
Room 3A	1,521	40 x 39	12	144	54	72	60	40	North
Room 3B	1,786	47 x 38	12	180	72	96	80	56	South
Rooms 3AB	3,393	87 x 39	12	360	144	192	140	88	South

* Permanent Set

Level Four: Exhibition Halls

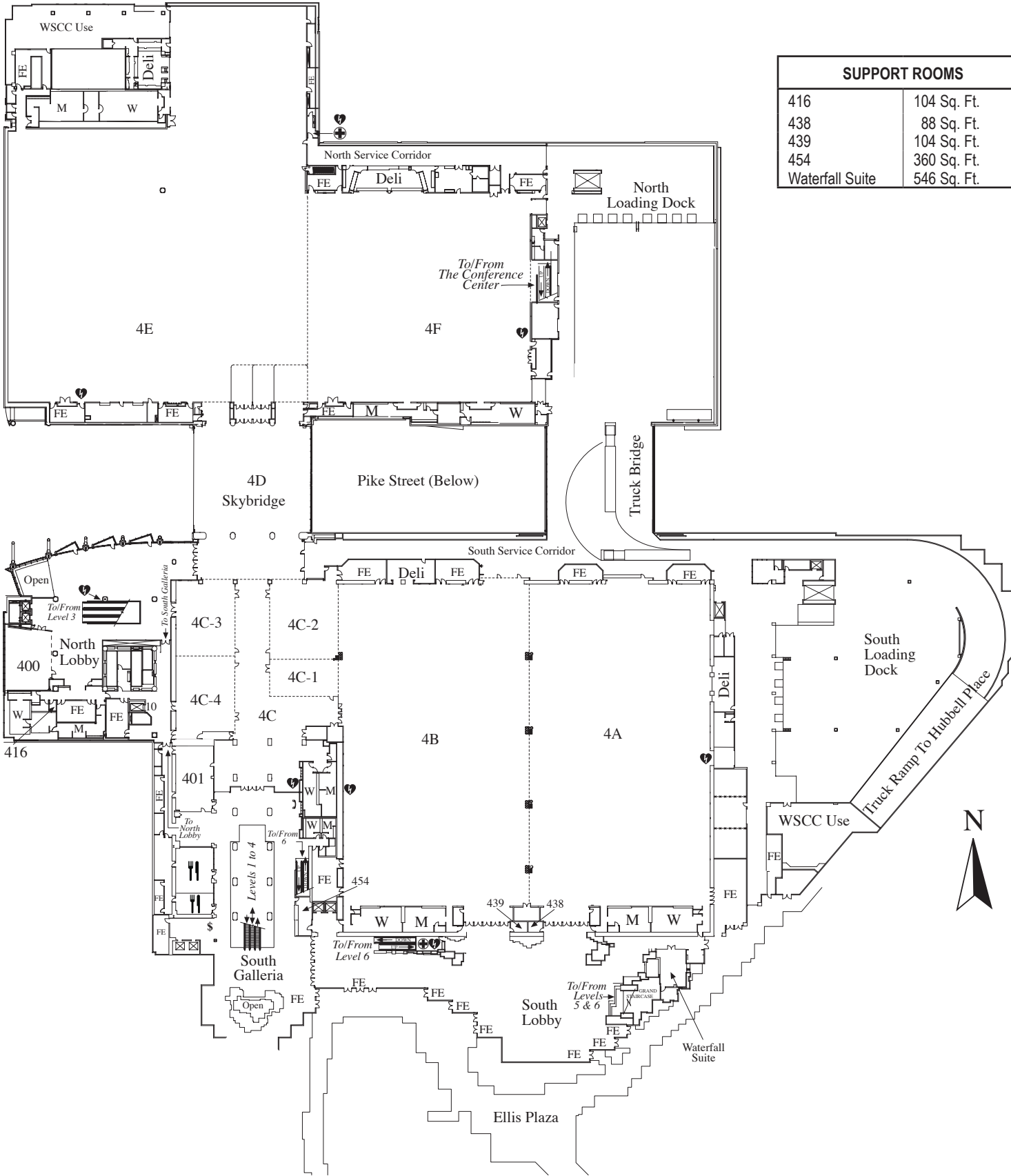

SUPPORT ROOMS	
416	104 Sq. Ft.
438	88 Sq. Ft.
439	104 Sq. Ft.
454	360 Sq. Ft.
Waterfall Suite	546 Sq. Ft.

Level Four: Exhibition Halls

EXHIBIT HALLS	Square Feet	Square Meter	Dimensions	Height	Theater	Classroom		Banquet B-10	Booth 10'x10'	Recommended Front
						3pp	4pp			
Hall 4A	40,000	3,716	260 x 143	25	4,032	2,226	2,968	2,310	186	North
Hall 4B	40,000	3,716	260 x 149	25	4,032	2,226	2,968	2,310	204	North
Hall 4C ¹	20,000	1,858	131 x 125	24	1,740	783	1,044	1,030	73	North
Halls 4AB	80,000	7,432	292 x 260	25	<u>7,000</u>	-	-	4,620	382	East
Halls 4BC	60,000	5,574	-	25	-	-	-	-	272	
Halls 4ABC	100,000	9,290	-	25	-	-	-	-	450	
South Lobby ²	12,000	1,115	-	50	-	-	-	500	-	
Hall 4D ¹	10,900	1,012	86 x 94	25	-	-	-	490	42	North
Hall 4E	64,200	5,964	242 x 220 + 100 x 110	25	5,568	2,634	3,512	2,710	329	West
Hall 4F	30,600	2,842	180 x 170	25	3,168	1,488	1,984	1,440	143	East
Halls 4EF	94,800	8,806	-	25	8,722	4,396	5,862	4,150	487	West
Halls 4DEF	105,700	9,819	-	25	-	-	-	-	515	
North Lobby	9,600	892	-	19	-	-	-	-	-	
Halls 4ABCDEF	205,700	19,109	-	25	-	-	-	-	957	
Halls 4BCDEF	165,700	15,393	-	25	-	-	-	-	779	
Halls 4CDEF	125,700	11,677	-	25	-	-	-	-	580	

¹4C and 4D dimensions Do Not include entry vestibule. Square feet/meters Do include vestibule.

²Useable square feet is 7,000.

MEETING ROOMS	Square Feet	Dimensions	Height	Theater	Classroom		Banquet B-10	Conference	Recommended Front
					3pp	4pp			
Room 400	1,824	48 x 38	19	176	72	96	80	48	South
Room 401	1,508	52 x 29	12	156	72	99	80	46	North
Room 4C-1	1,650	30 x 55	14	156	72	99	80	-	East
Room 4C-2	3,520	64 x 55	14	364	165	220	200	-	South
Room 4C-3	2,928	61 x 48	14	286	120	160	180	-	North
Room 4C-4	2,928	61 x 48	14	286	120	160	170	-	North
Rooms 4C-1,2	5,170	94 x 55	14	567	255	340	280	-	North
Rooms 4C-3,4	5,856	122 x 48	14	660	210	280	300	-	North

Level Five: Show Offices

SHOW OFFICES	Square Feet	Dimensions	Height	Banquet B-10	Conference
Room 504	351	27 x 13	9	20	16
Room 505	364	28 x 13	9	20	16
Room 506	364	28 x 13	9	20	16
Room 507	208	16 x 13	9	10	8
Room 508	260	20 x 13	9	10	8
Room 509	260	20 x 13	9	10	8
Rooms 504-505	715	55 x 13	9	40	-
Rooms 504-506	1,079	83 x 13	9	60	-
Rooms 505-506	728	56 x 13	9	40	-

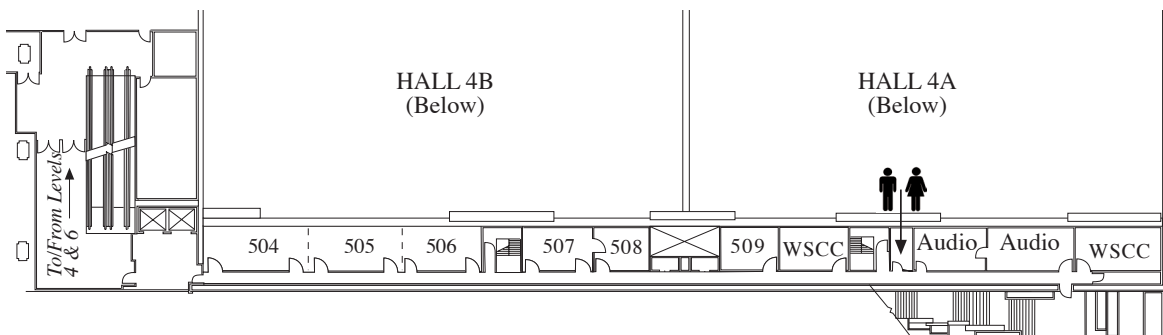

Level Six: Ballrooms & Meeting Rooms

SUPPORT ROOMS	
Suite A	209 Sq. Ft.
Suite C	176 Sq. Ft.
Room 657	192 Sq. Ft.

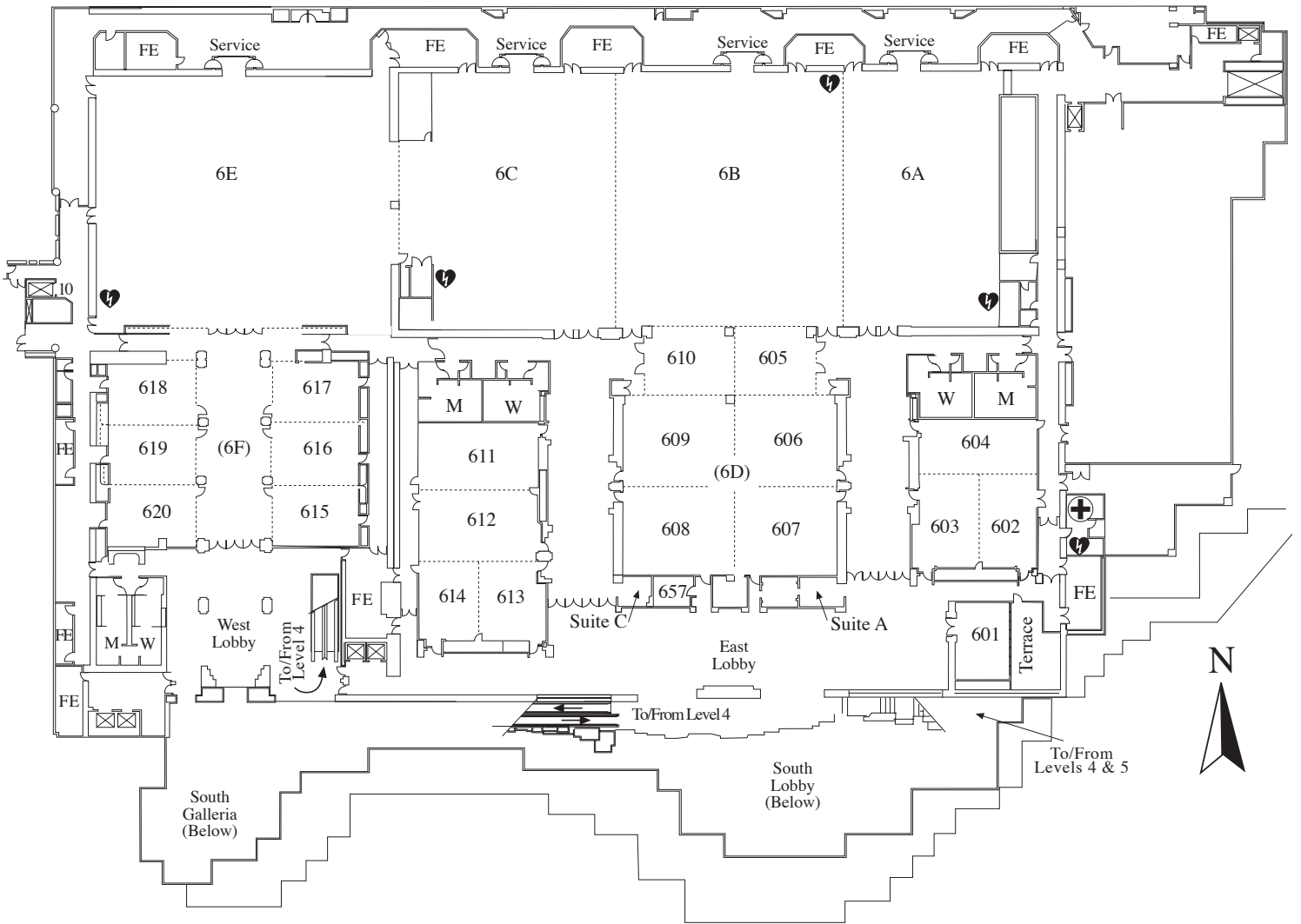









Level Six: Ballrooms & Meeting Rooms

BALLROOMS	Square Feet	Dimensions	Height	Theater	Classroom		Banquet B-10	Booth		Recommended Front
					3pp	4pp		8'x10'	10'x10'	
Ballroom 6A	8,236	116 x 71	21	<u>850</u>	342	<u>456</u>	540	54	36	North
Ballroom 6B	11,500	115 x 100	21	1,150	570	760	<u>770</u>	73	55	North
Ballroom 6C	9,628	116 x 83	21	<u>1,000</u>	456	<u>608</u>	<u>660</u>	56	51	North
Ballroom 6D (605 thru 610)	10,152	-	16	<u>1,025</u>	477	596	560	65	52	South
Ballroom 6E	15,048	132 x 114	21	1,584	741	988	990	90	72	North
Ballroom 6F (615 thru 620)	9,102	111 x 82	14	-	-	-	500	44	38	N/A
Ballrooms 6AB	19,836	171 x 116	21	<u>2,296</u>	1,023	1,364	1,370	99	81	North
Ballrooms 6BC	21,228	183 x 116	21	<u>2,494</u>	1,026	1,368	1,410	122	104	North
Ballrooms 6ABC	29,580	255 x 116	21	3,111	1,551	2,068	2,080	154	136	East
Ballrooms 6ABCD	39,732	-	21/16	4,176	-	-	2,610	219	188	North
Ballrooms 6EF	24,150	-	21/14	-	-	-	1,186	128	103	N/A
East Lobby	7,700	-	16	-	-	-	-	-	-	
West Lobby	3,500	-	16	-	-	-	-	-	-	
MEETING ROOMS	Square Feet	Dimensions	Height	Theater	Classroom		Banquet B-10	Conference		Recommended Front
					3pp	4pp				
601	782	34 x 23	16	60	30	40	40	28		South
602	1,188	44 x 27	16	108	42	56	60	40		North
603	1,144	44 x 26	16	99	42	56	60	40		North
604	1,219	53 x 23	16	120	54	72	80	46		East
602-603	2,332	53 x 44	16	<u>220</u>	108	144	140	-		East
602-604	3,604	68 x 53	16	<u>336</u>	<u>144</u>	<u>192</u>	240	-		North
605	1,110	37 x 30	16	91	42	60	60	36		West
606	1,886	46 x 41	16	167	81	108	110	48		West
607	1,840	46 x 40	16	171	84	112	110	56		South
608	2,000	50 x 40	16	190	96	128	120	56		South
609	2,050	50 x 41	16	186	90	120	120	56		East
610	1,230	41 x 30	16	112	54	72	60	40		East
605 & 610	2,280	76 x 30	16	209	117	156	120	-		West
605-606	2,996	-	16	<u>270</u>	132	176	200	-		South
605-607	4,882	-	16	<u>517</u>	228	304	330	-		South
606-607	3,772	82 x 46	16	<u>373</u>	<u>165</u>	<u>220</u>	250	-		South
606-609	7,872	96 x 82	16	<u>816</u>	414	552	420	-		South
608-609	4,100	82 x 50	16	<u>391</u>	<u>156</u>	<u>224</u>	270	-		South
608-610	5,330	-	16	<u>534</u>	266	359	330	-		South
609-610	3,280	-	16	<u>296</u>	156	208	210	-		South
611	1,537	53 x 29	16	<u>132</u>	54	72	80	48		West
612	1,643	53 x 31	16	<u>156</u>	81	108	110	48		West
613	1,044	36 x 29	16	84	30	40	60	32		North
614	936	36 x 26	16	84	30	40	60	32		North
611-612	3,233	61 x 53	16	<u>364</u>	<u>165</u>	<u>200</u>	180	-		North
611-614	5,194	98 x 53	16	<u>550</u>	<u>255</u>	<u>340</u>	280	-		North
612-614	3,604	68 x 53	16	<u>350</u>	<u>180</u>	<u>240</u>	200	-		North
613-614	2,016	56 x 36	16	<u>184</u>	90	126	120	-		West
615	1,014	39 x 26	14	96	42	60	60	40		East
616	1,092	39 x 28	14	96	42	60	60	40		East
617	1,053	39 x 27	14	96	42	60	60	40		East
618	1,053	39 x 27	14	96	42	60	60	40		West
619	1,092	39 x 28	14	96	42	60	60	40		West
620	1,014	39 x 26	14	86	40	60	60	32		West
615-616	2,145	55 x 39	14	220	108	144	130	-		North
615-617	3,198	82 x 39	14	360	168	224	180	-		North
616-617	2,184	56 x 39	14	220	108	144	130	-		North
618-619	2,145	55 x 39	14	220	108	144	130	-		North
618-620	3,198	82 x 39	14	360	168	224	180	-		North
619-620	2,106	54 x 39	14	241	108	144	120	-		North

Room Set Capacity Information

1. Set Identification; Classroom = 18" wide tables with (3) people per 8' table ("3pp") or (4) people per 8' table ("4pp"); Theater = Theater-style seating, chairs may be linked based on amount set; B-10 = 72" round table for 10 people; Conference = Seating for all people at a square or rectangular table set. Larger sizes may be a hollow square. All sets are with 21" wide chairs.
2. All published capacities will vary according to peripheral room set requirements. Large head tables, audio/visual equipment, staging materials, tables and catering service may substantially reduce these capacities. Depending on the peripheral requirements, perimeter seating may be allowed.
3. Capacities listed as underlined, i.e. 220, indicate a center aisle is included. Ballroom and Exhibit Hall sets include one or more aisles. Other numbers reflect room sets without center aisles.
4. Theater and Classroom sets in Ballrooms include an average of 22' at the front of the room for production.
5. Banquet (B-10) capacities are based on maximum seating in rooms. Provisions for head tables, dance floor or audio/visual will reduce capacity. All B-10 sets use 72" diameter round tables on 11' centers. Standard sets are straight rows though some sets are staggered when necessary to maximize capacity.
6. Rooms 601-614 Theater and Classroom sets include front of room space (average 10' to 12' deep) adequate for a riser at the front.
7. Rooms 615-620, 4C-1, 4C-2, 4C-3, 4C-4 Theater and Classroom sets include front of room space (average 9' to 10' deep) adequate for a riser at the front.
8. Rooms 201-206, 208-214, 2A, 2B, 301-310, 3A, 3B, 400, 401, Theater and Classroom sets include front of room space (averaging 9' to 10' deep). Risers may not be set in these rooms.
9. Rooms 208, 209, 210 and 301 are executive conference rooms with higher quality finishes, furnishings and equipment and are permanent room sets. Contact WSCC Sales for more details.
10. Sample room set diagrams for these maximum sets are available upon request.

Notes:

Legend	
	AED Device
	First Aid
	Accessible Entrance/Lift
	Fire Exit
	Cash Machine
	Food/Beverage
	Bar
	SCVB/Citywide Concierge Center



Washington State
Convention Center
at convention place

800 Convention Place | Seattle, WA 98101
206-694-5030 | www.wsc.com